

# A Living on Top

Penthouse Pafekuto, Ghaziabad, Conarch Architects

High rise living is synonymous with a detached and soloed existence. The design idea sought to change that for the client. Conceptualising to establish this connection to outdoors, even in the spaces deep inside the unit, **Conarch Architects** have designed and customised the **Penthouse Pafekuto** to create the green ambience. Crucial to the story of the home, this link to the outdoors invokes a feeling of 'front yard', a rarity in high rise setting.



**P**ried-à-terre for a family, Penthouse Pafekuto is a resting place to facilitate their frequent visits to the city. Designed as a lively and a sensual world, it is a multi-level penthouse with 8000 square feet of indoor area and 6000 square feet of outdoor space spread across three levels. The design vision is centred on transforming generic apartment units into a functional, versatile and inspiring living space that honours client specific needs and reflects their lifestyle.

To create a spacious home, two separate apartments on top of one another were combined into this luxury penthouse and ownership rights were acquired to the high rise tower's terrace above for private use. One apartment is primarily designed as a master suite, private workspace, guest bedroom and a sit out area. The second apartment, internally connected with the first one, includes a spread out indoor & outdoor living area, a kitchen and three bedrooms. Connecting the two units internally has major

advantage which is passive ventilation. The staircase opening between the levels acts as a chimney and helps release hot air from the window openings at the upper floor, inducing natural air moment in the apartment. This restricts the need for mechanical air conditioning in extremely hot days.

The focal point of the space is the cantilevered floating wood steps with the artistic fall protection in a Prussian blue backdrop. Created in a simple style that belies its complexity, this protagonist of a staircase is meant to sit lightly to let light and conversations through, emphasising the interconnected relationship between the levels.

The spatial form in the project has emerged from a host of variables and constraints, such as the needs of a family with teenage children, structural limitations of the high rise building and limited flexibility in relocating plumbing and electrical services. The architects ripped down the walls, overhauled



the space by custom designing the penthouse in its entirety with the melody of balance, contrast, proportion and colour while grounding every move in logic and aesthetic precepts.

The spaces were laid out such that bedrooms, living areas and even kitchen have a visual connection to the 'green' outdoor terraces. Some of the areas open directly to these staggered, double height open spaces located at two levels.

The connection to the outdoors has another benefit of getting in the daylight. The entire unit is effectively illuminated with natural light,

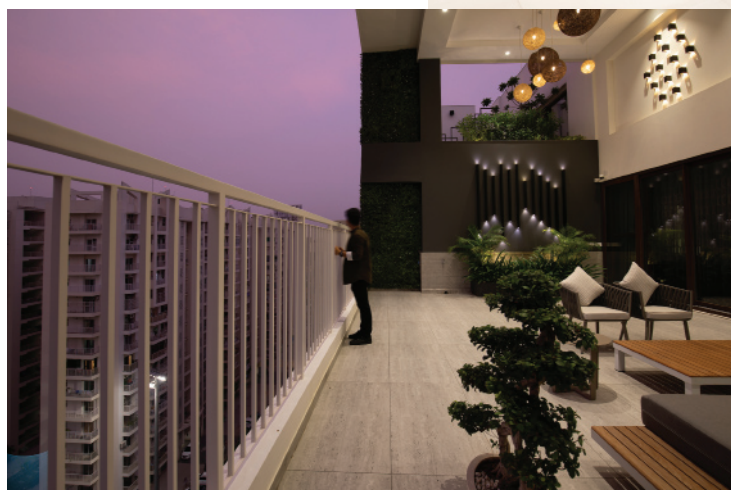

eliminating the need for artificial lighting throughout the day and significantly reducing energy loads. The exterior glass letting in the light remains shaded due to deep overhangs of the outdoor terraces. Since there is no direct incident solar radiation on the glass, the heat gain is minimal, resulting in low cooling load requirement.

To establish a sensorial connection and meet the human necessity to connect with natural systems, both the levels extend into double height outdoor areas. The upper level leads to the tower's roof level terrace, unfolding into a place for gathering, refuge and play. At a time when birds are becoming increasingly scarce in the city, the roof terrace with its hydroponic 'Living wall', Plumeria & bonsai trees, Ficus

trees, flowering plants and water feature can be seen attracting migratory birds. The resulting benefits are two prongs, a well-designed green roof is slowly becoming an ecosystem for bird-habitat regeneration and the residents can emotionally and physically benefit from spending more time outdoors interacting with all things natural. ▲







**Immidiate\_Greens\_1201**



**Immidiate\_Greens\_1401**



**fact file:**

Project Name	: Jacarandà
Project name	: Penthouse Pafekuto
Location	: VIP Addresses, Ghaziabad, Uttar Pradesh, India
Architect's Firm	: Conarch Architects
Principal Architect	: Ar. S.K. Goel
Project Lead Architect	: Ar. Nitish Goel
Project Team	: Pushplata Dinkar, Tanya Kumar, Usha Narain, Suman Singh.
Completion	: 2018
Gross Built Area	: 18,900 Square Foot
Photo credits	: Vibhor Yadav, Conarch Architects



**S K Goel, Co-founder, Conarch Architects**

Founded in 1988 by Ar. Rakesh Dhar and Ar. S.K. Goel, Conarch Architects seek to design spaces that consistently express the needs, aspiration and identity of the occupants. The firm's portfolio reflects the

abiding desire in enriching human experience, thriving on our obsession of continuously improving upon the design solutions, bettering our previous best. They embrace the myriad desires of client and project considerations to craft solutions unique to the given parameters by considering each project as a design opportunity than a design problem. The team 'own' their projects from the day of the inception of its idea to the day it is occupied. As designers, they don't think of architecture as separate from interiors and the approach towards space creation blurs the distinction and blends the two.